

# Need 2 Know #12

Locks & Codes	Page 2 – back of entry door, below Welcome
Front Hall Entrance	Page 3 – back of closet door
Kitchen	Page 4 – Fridge, below Welcome
Patio	Page 5 – inside main patio door
Living Room	Page 6 – left of TV
Bathroom on Main Floor	Page 7 – back of door
Bathroom on 2 <sup>nd</sup> Floor	Page 8 – back of main door
Master Bedroom	Page 9 – back of door
Guest Bedroom	Page 10 – back of door
Kids Bedroom	Page 11 – back of door

## Notes

Noise – We have many residents & guests, please keep noise level down at all times.

Parking – Only park in your spot identified by the condo number. Unmarked spaces are available on a first come first served basis.

Beach Area – Return all lounge chairs to their storage area under the stairs. Do not take chairs into the water as this promotes premature rusting.

Garbage – Garbage from the unit needs to be removed and placed in the dumpster at the front of the complex, just south of the entrance from the road.

Need 2 Know – Locks & Codes (all access codes will be given upon request)

- One key operates both locks on the front door. Note: you must unlock the top deadbolt first and then the bottom lock.

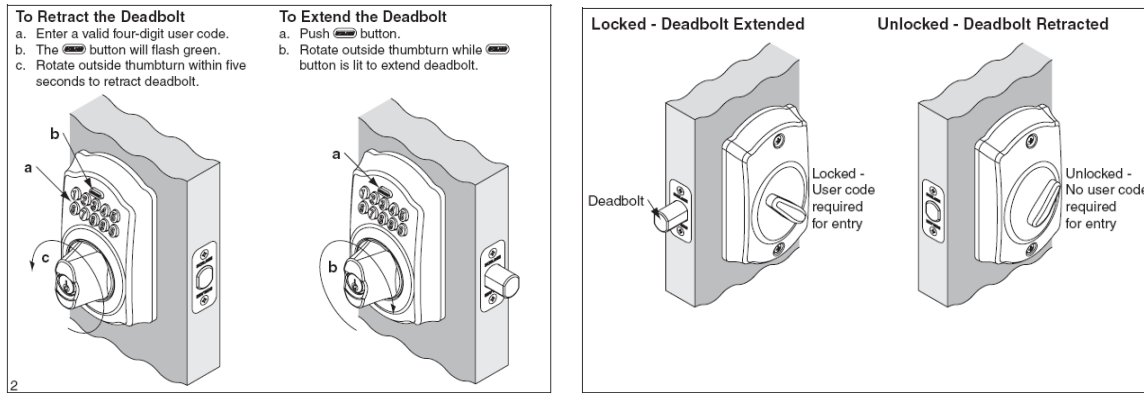

**Key Override**

NOTE: Key will both extend and retract deadbolt.

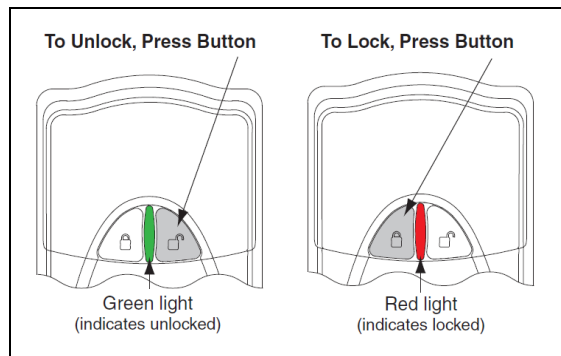
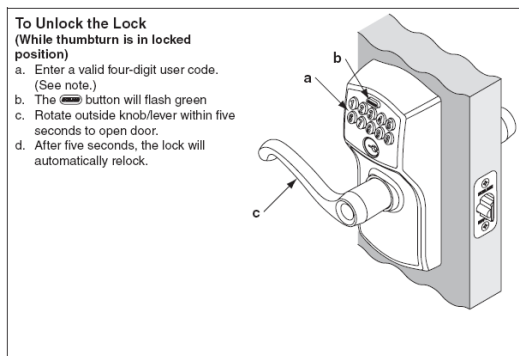
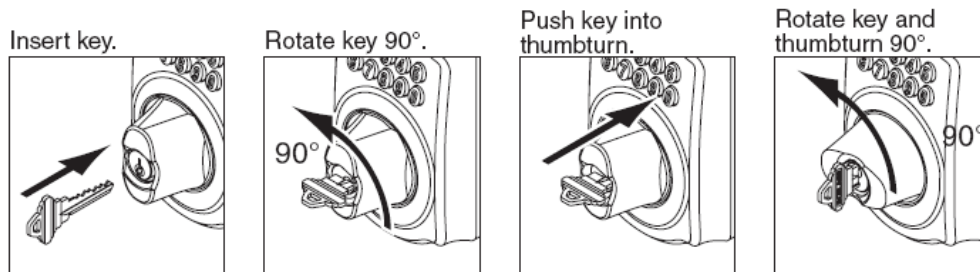

**Key Override**

NOTE: Key does not retract latch.

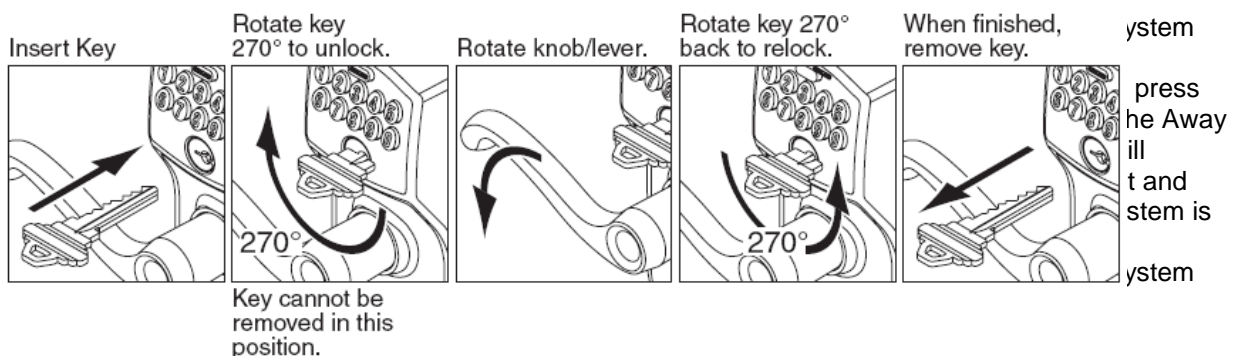

system  
 press  
 the Away  
 ill  
 t and  
 stem is  
 system

## Need 2 Know – Front Hall Entrance

- **To Arm Security System:** Press the Away button on the security screen and enter your four digit code. The keypad will immediately start to beep indicating your 30 second count down to depart the unit and lock the front door. The LED light on the keypad will turn from green to red indicating that the system is armed.
- **To Disarm Security System:** When re-entering the unit if the alarm has been armed, the keypad will start to emit a constant tone reminding you to disarm the system. Press the Off button and enter your four digit code. The LED light will turn from red to green indicating that you have successfully disarmed the system. You have 30 seconds to disarm the system upon entering the unit.
- To enter tennis court, use the key on one of the key sets hanging in the front closet. Lights are located on the pole to the North outside of the court.

### Inventory

Eureka Bagless Vacuum  
Sun Umbrellas x 2  
Tennis Rackets x 4  
Broom & Dust Pan  
Mop & Bucket  
Instant On-Demand Hot Water System

## Need 2 Know – Kitchen

- Use Cerama Bryte, a dry paper towel and rub hard for stove top
- Water from fridge is filtered via under counter system (not the fridge unit)
- All cleaning supplies located under sink
- Dishwashing soap is located in counter mounted dispenser to right of tap
- Music System: There is an under-counter CD/Stereo system located beside the fridge. It is equipped with a built in CD player, and an FM radio.

### Inventory

Electric Kettle  
Coffee Grinder  
Blender  
4 Slice Toaster  
Coffee Maker  
Frigidare Electric Range  
Kenmore Refrigerator  
Kenmore Dishwasher  
Whirlpool Microwave  
Table & 6 chairs & 2 stools  
Pot Set  
Cutlery 8 settings  
Patio Glassware  
Dinnerware settings  
Can Opener & Cork Screw  
Under Counter Radio

### Need 2 Know – Patio

- Clothes racks are mounted on the wall. To use, flip up the silver cover and extend the rods by pulling away from the wall. To close, flip up silver cover, and push rods towards wall.
- Electric BBQ – The trick to using an electric BBQ is to keep the lid closed to retain the heat.

Note: A/C will turn off if doors left open for longer than 5 minutes.

### Inventory

Patio Furnishings (4 chairs & round table)  
Electric BBQ

## Need 2 Know – Living Room

- There are three remote controls for the TV system in the living room. Philips TELEVISION, and Philips BLU-RAY are both labelled. The small silver remote is for the SAT box.
- To Watch TV: Turn on the SAT box with the silver remote. A green display on the SAT box will display the channel (versus the time when it is off). Turn on the TV by pressing the TV power button located in the middle top of the remote. A white indicator on the TV will light in the bottom centre. Ensure that the TV is on the correct input by pressing the SOURCE button and cycle through to the SAT input. Channels and electronic program guides can be controlled with the SAT (silver) remote.
- To Watch a DISC: Turn the TV on as per above. On the BluRay remote, press the power button located in the top centre of the remote. Insert DISC.
- To Watch Internet Apps: On the TV remote, select the appropriate button.
- To Play Xbox: Turn the TV on as per above. Turn on the Xbox, press SOURCE on TV remote until you reach GAME.
  
- Turning Off System: Press the power button on each remote for each device that is in use.
  
- Movies are located under TV.

### Inventory

Philips 60" Smart HDTV w/Remote  
Philips Blu-Ray Player  
Movies  
Satellite Receiver w/Remote  
Xbox 360 & controllers & Games  
Xbox Guitar  
Panasonic Cordless 2 Line Phone  
Leather Sectional  
Chair  
Glass Tops

Need 2 Know – Bathroom on Main Floor

- Electronic Timers for Exhaust Fan & Shower Lights

Inventory

Washer and stacking Dryer

<u>Towels</u>	Out	Stored
Face	2	2
Hand	1	1
Body	2	0
Mat	1	1
Beach	6	

Need 2 Know – Bathroom on 2<sup>nd</sup> Floor

- Electronic Timers for Exhaust Fan

Inventory  
Hair Dryer

<u>Towels</u>	Out	Stored
Face	4	2
Hand	1	1
Body	4	0
Mat	1	1



## Need 2 Know – Master Bedroom

- All linens for the king bed are located in the closet on the top shelf on the left hand side.
- Asus computer is mounted on the back of the LCD. To power on, press large round button found on the right hand side of the rear of the LCD on the PC

### Inventory

King Size Pillows x 2  
Complete Set Of King Sheets x 2  
Body Towels x 2  
Extra Pillows x 2  
Extra light cotton blanket  
Anti-Allergy pillow and mattress covers  
Lazboy Duvet  
Panasonic Cordless 2 Line Phone  
Computer w/19" LCD & Internet  
Samsung Laser Printer  
Alarm Clock

## Need 2 Know – Guest Bedroom

- All linens for the queen bed are located in the closet.

### Inventory

Queen Size pillows x 2  
Complete Set Of Queen Sheets x 2  
Body Towels x 2  
Extra light cotton blanket  
Anti-Allergy pillow and mattress covers  
Lazboy Duvet  
Alarm Clock  
Ironing Board & Iron (in closet)

### Need 2 Know – Kids Bedroom

- CAUTION – when on top bunk, be aware of fan.
- All linens for the beds are located in the closet on the top shelf on the left hand side.
- Crib is located in the closet – note: MUST BE ASSEMBLED
  - No Bedding For Crib is Provided – Please Bring Your Own Bedding

### Inventory

Standard size pillows x 2  
Complete Set Of Double Sheets x 2  
Complete Set Of Single Sheets x 2  
Extra light cotton blankets x 2  
Bunk Bed (Single & Single)  
Dresser  
Anti-Allergy pillow and mattress covers  
Lazboy Duvets  
Alarm Clock  
Crib  
Aerobed Twin with pump  
Fisher-Price Space Saver Highchair (stored in closet)